

THE INFORMATION CONTAINED IN THIS DRAWING IS THE SOLE
PROPERTY OF L-COM, INC.. ANY REPRODUCTION IN PART OR WHOLE
WITHOUT THE WRITTEN PERMISSION OF L-COM, INC. IS PROHIBITED.

REVISIONS			
REV	DESCRIPTION	DATE	APPROVED
A	INITIAL RELEASE	09/08/11	D.GRIFFIN

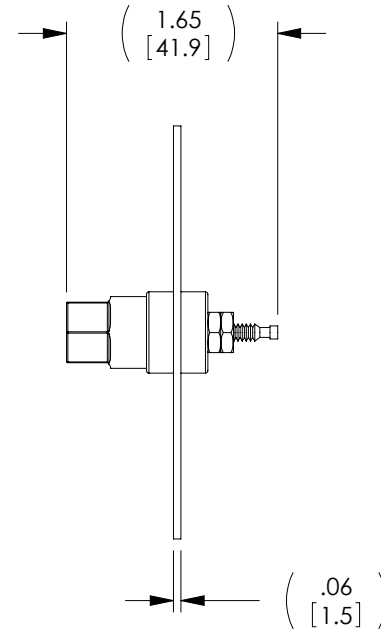
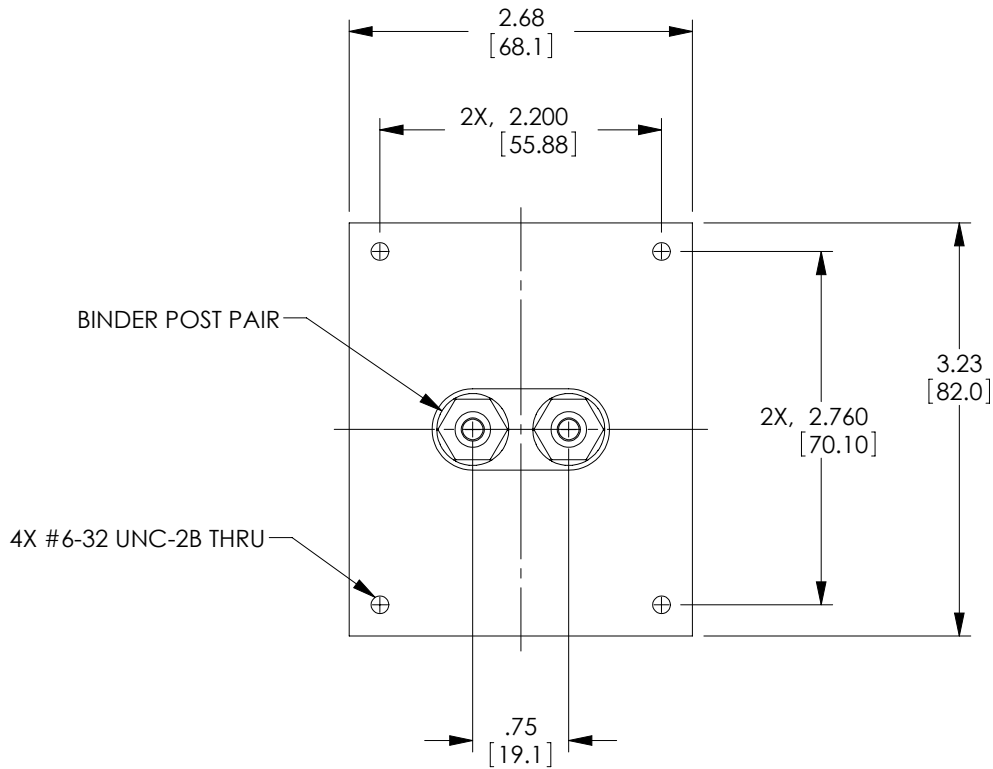

NOTES:

1. PANEL MATERIAL: .06 [1.5] THICK COLD ROLLED STEEL
2. PANEL FINISH: FLAT BLACK POWDERCOAT
3. KIT CONTAINS 4, #6-32 UNC-2A PAN HEAD SCREWS.
4. ALL DIMENSIONS SHOWN ARE FOR REFERENCE ONLY.
5. COMPONENT ASSEMBLY SHALL BE INDIVIDUALLY PACKAGED IN ACCORDANCE WITH L-COM SPECIFICATION PS-0031 & PS-0014.

UNLESS OTHERWISE SPECIFIED, DIMENSIONS ARE IN INCHES [mm] OVERALL CABLE LENGTH TOLERANCE: ≤12 [305] = +1 [25] / -0 >12 [305] ≤60 [1524] = +2 [51] / -0 >60 [1524] ≤120 [3048] = +4 [102] / -0 >120 [3048] ≤300 [7620] = +6 [152] / -0 >300 [7620] = +3% / -0% ALL OTHER DIMENSIONAL TOLERANCES: .X = ±.2 .XX = ±.02 .XXX = ±.005 PROJECTION 	APPROVALS	DATE	 45 BEECHWOOD DRIVE NORTH ANDOVER, MA 01845	
	DRAWN BY D. PARHAM	09/08/2011		
	CHECKED BY D. FRISIELLO	09/08/2011	CATEGORY SUB PANEL	
	APPROVED BY M. MARTINEZ	09/08/2011	PRODUCT DESCRIPTION USP SUB-PNL/BIND PST BK/RD BLK	
COLOR VARIATIONS MAY OCCUR	SIZE A	FSCM NO. 43321	DWG. NO. USP-BPRB	REV. A
	SCALE: NONE	CAD FILE: USP-BPRB.SLDDRW	SHEET 1 OF 1	