

THE INFORMATION CONTAINED IN THIS DRAWING IS THE SOLE PROPERTY OF L-COM, INC. ANY REPRODUCTION IN PART OR WHOLE WITHOUT THE WRITTEN PERMISSION OF L-COM, INC. IS PROHIBITED.

REVISIONS			
REV	DESCRIPTION	DATE	APPROVED
A	INITIAL RELEASE	1/22/14	D. GRIFFIN

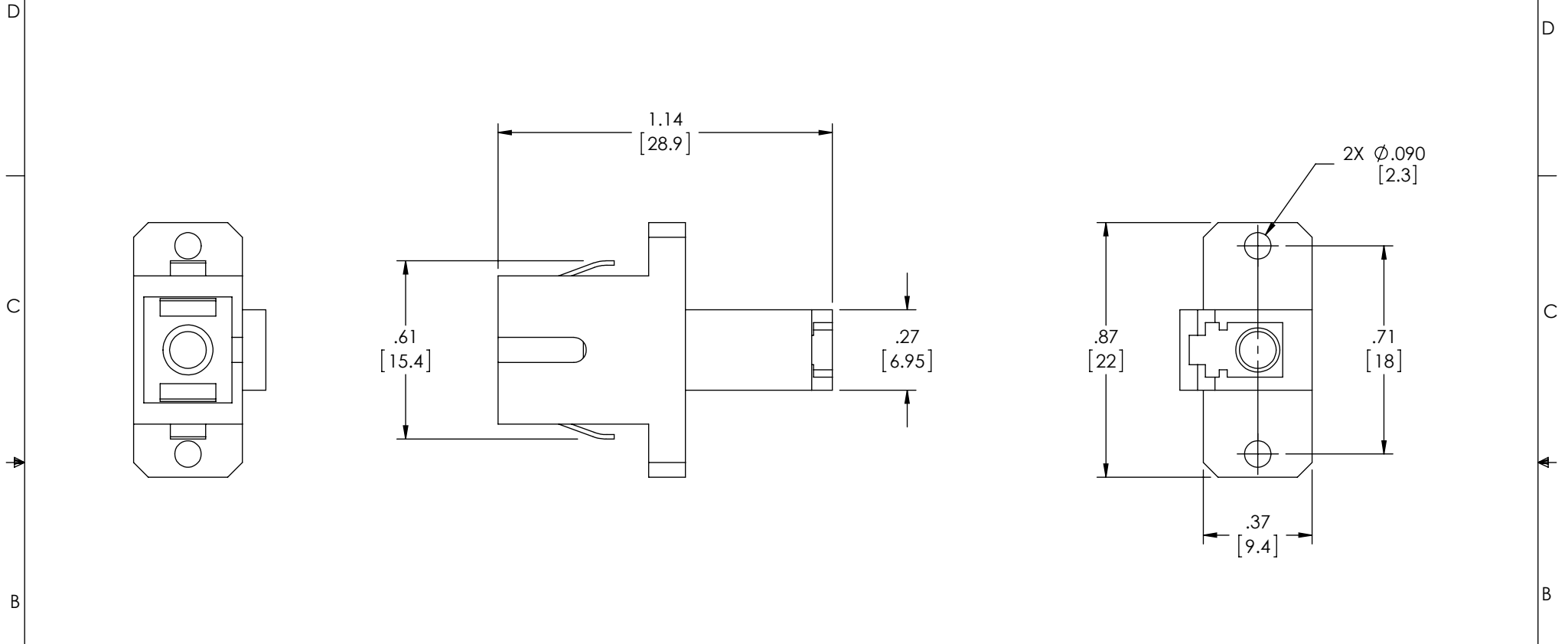

NOTES:

MATERIAL:

HOUSING: PBT, THERMOPLASTIC (BLUE)
 MOUNTING TABS: STAINLESS STEEL
 ALIGNMENT SLEEVE: PHOSPHOR BRONZE
 DUST CAP: RED (NOT SHOWN)
 DUST CAP: WHITE (NOT SHOWN)

MISCELLANEOUS:

INSERTION LOSS: ≤0.5dB
 RETURN LOSS: ≥45dB
 TEMPERATURE RANGE: -40°C TO +70°C
 DURABILITY: <0.2dB CHANGE AFTER 500 CYCLES

REGULATORY COMPLIANCE:

CE2011/65/EU(RoHS DIRECTIVE)

UNLESS OTHERWISE SPECIFIED, DIMENSIONS ARE IN INCHES [mm] OVERALL CABLE LENGTH TOLERANCE: ≤12 [305] = +1 [25] / -0 >12 [305] ≤60 [1524] = +2 [51] / -0 >60 [1524] ≤120 [3048] = +4 [102] / -0 >120 [3048] ≤300 [7620] = +6 [152] / -0 >300 [7620] = +5% / -0% ALL OTHER DIMENSIONAL TOLERANCES: .X = ±.2 [5.08] .XX = ±.02 [5.1] .XXX = ±.005 [1.3]	APPROVALS D. CASTRO	DATE 1/21/14	45 BEECHWOOD DRIVE NORTH ANDOVER, MA 01845
	CHECKED BY D. FRISIELLO	DATE 1/21/14	
PROJECTION 	CONFIGURATION DETAILS OF UNDIMENSIONED FEATURES MAY VARY	PRODUCT DESCRIPTION FIBER ADPTR SMPX LC-SC MM	SCALE: NONE CAD FILE: FOA-020C.SLDDRW SHEET 1 OF 1
COLOR VARIATIONS MAY OCCUR	SIZE A	FSCM NO. 43321	DWG. NO. FOA-020C